

NIO SIMULATION ADULT LOCATING + DEPLOYING

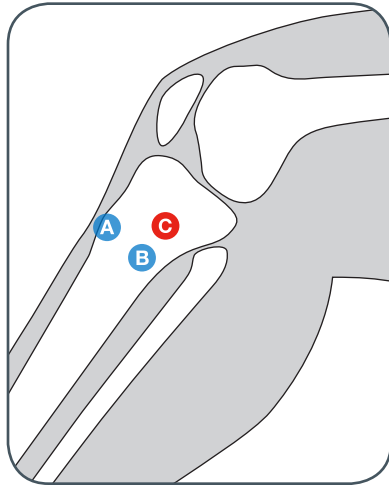

Tibial Access Site:

- A. Tibial tuberosity
- B. 2cm (1in) medially, towards inner leg
- C. 1cm (.5in) proximally, up towards knee

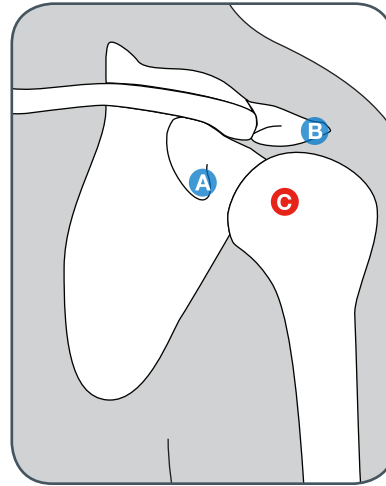

Humeral Access Site:

- Abduct patient's arm w/ hand over umbilicus
- A. Locate coracoid process
- B. Locate acromion
- C. Locate point halfway between A and B, and move down approx. 2cm (.75in) to greater tubercle

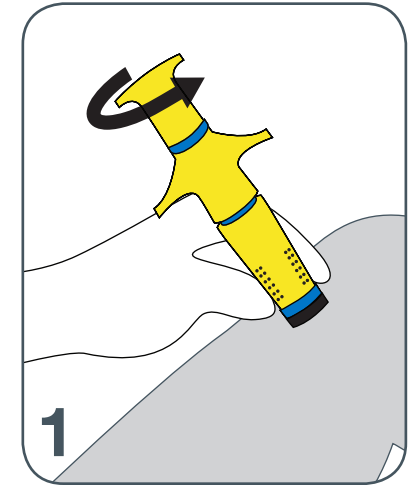

1. With non-dominant hand, hold NIO-SIM-A by textured dots at a 90° angle to access site and maintain downward pressure. Unlock safety cap by rotating 90° in either direction until aligned with trigger wings.

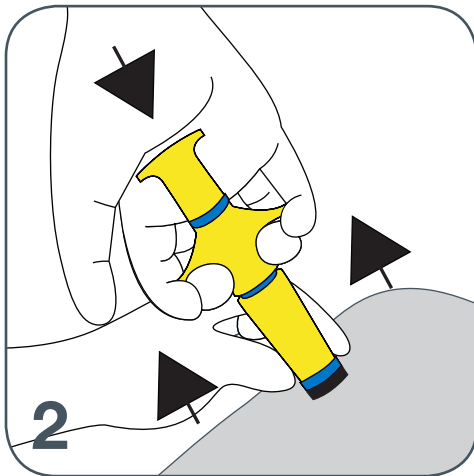

2. With dominant hand, place palm over safety cap and apply downward pressure. While maintaining downward pressure with palm, use fingers to pull the trigger wings up. This is how the device is deployed.

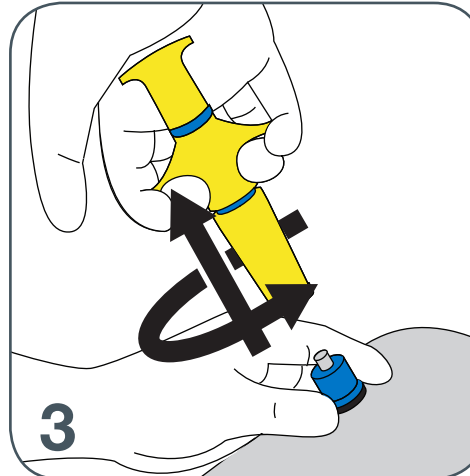

3. Gently lift NIO-SIM-A in an upward and rotating motion.

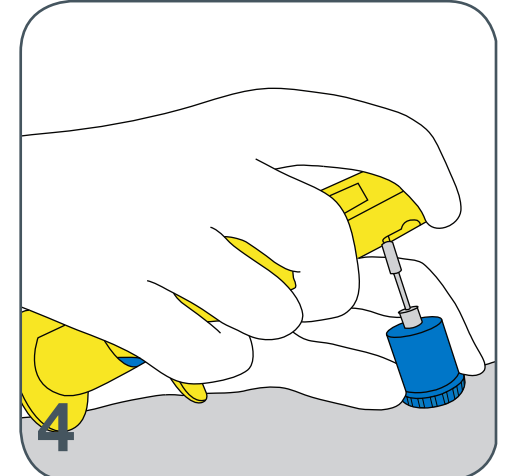

4. Remove trocar from cannula.